

Core Wire for Welding Electrodes

General Information



- ▷ Special Characteristics
  - Superior welding efficiency
  - Various grades according to application
- ▷ Grade : AWS ER 308, 308L, 308LSi, 309, 309L, 309LSi, 316, 316L, 316LSi, 317, 317L, 321, 347, 410, 430 and etc.
- ▷ Diameter : 1,60mm ~ 5,00mm
- ▷ Packing : Coil

Packing Type



Coil

Dimension & Tensile Strength

Diameter mm	Tolerance mm	Ovality mm	Tensile Strength N/mm <sup>2</sup> (kgf/ mm <sup>2</sup> )
1,60	-0,05 ~ -0,03	Max.0,02	735(75) - 1080(110)
2,00			
2,60			
3,20			
4,00			
5,00			

Diameter Inch	Tolerance Inch	Ovality Inch	Tensile Strength ksi
1/16	-0,0020 ~ -0,0012	Max 0,0008	107 - 156
5/64			
3/32			
1/8			
5/32			
3/16			

Packing

Diameter mm	Type	Inside dia. of Coil In.(mm)	Weight LBS (Kg)
1,60	Coil	16(410)	130(60)
2,00 - 5,00	Coil	24(610)/28(710)	220(100)/330(150)

**Mig Wire for welding**

**General Information**



- ▷ Special Characteristics
  - Superior welding efficiency for Automatic machine
  - Various grades according to application
- ▷ Grade : AWS ER 308, 308L, 308LSi, 309, 309L, 309LSi, 316, 316L, 316LSi, 317, 317L, 321, 347, 410, 430 and etc.
- ▷ Diameter : 0,6mm ~ 1,80mm
- ▷ Packing : Spool, Pail Pack and etc.
- ▷ Application : Mig Welding Use

**Packing Type**



Spool

**Dimension & Tensile Strength**

Diameter mm	Tolerance mm	Ovality mm	Tensile Strength N/mm <sup>2</sup> (kgf/ mm <sup>2</sup> )
0,80	-0,03 ~ -0,01	Max,0,015	735(75) - 1180(120)
0,90			
1,00			
1,20			
1,60			

Diameter Inch	Tolerance Inch	Ovality Inch	Tensile Strength ksi
0,030	-0,0012~ -0,0004	Max 0,0006	107 - 170
0,035			
0,039			
0,045			
1/16			

**Specification of Winding & Packing**

Packing	Diameter In. (mm)	Weight LBS(kg)	Winding (mm)	
			Cast	Helix
Plastic Spool +Carton box	0,030-0,045 (0,80- 1,20)	10(5)	27 - 51 (700-1300)	Max,0,4 (Max,10)
	0,030-1/16 (0,80-1,60)	30/33  (12,5)/(15)	27 - 51 (700-1300)	Max,0,4 (Max,10)

➤ Spool Dimension

Winding Capa. lbs(kg)	Dimension (mm)						
	øA	B	øC	D	øE	øF	G
10(5)	7,83 (199)	2,16 (55)	4,13 (105)	1,77 (45)	2,05 (52)	0,45 (11,4)	1,75 (44,5)
30(12,5) 33(15,0)	11,0 (279)	4,02 (102)	7,13 (181)	3,50 (89)	2,05 (52)	0,45 (11,4)	1,75 (44,5)

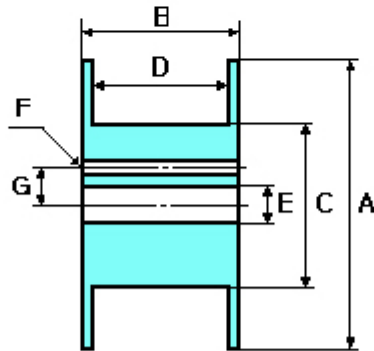

**Tig Rod for Welding**

**General Information**



- ▷ Special Characteristics
  - Superior welding efficiency for manual process
  - Various grades according to application
- ▷ Grade : AWS ER 308, 308L, 308LSi, 309, 309L, 309LSi, 316, 316L, 316LSi, 317, 317L, 321, 347, 410, 430 and etc.
- ▷ Diameter : 1,2mm ~ 5,0mm
- ▷ Packing : Plastic Tube and etc.
- ▷ Application : Tig Welding Use

**Packing Type**

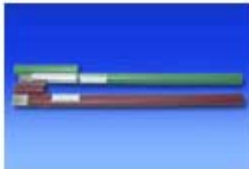

Plastic Tube

**Dimension & Tensile Strength**

Diameter mm	Tolerance mm	Length mm	Tensile Strength N/mm <sup>2</sup> (kgf/mm <sup>2</sup> )
1,20	-0,05 ~ -0,03	900 (-0, +15)	735(75) - 1180(120)
1,60			
2,00			
2,40			
2,80			
3,20			
4,00			
5,00			

Diameter Inch	Tolerance Inch	Length Inch	Tensile Strength kSI
0,045	-0,0012 ~ +0,0004	36 (+0,- 1/2)	107 - 170
1/16			
5/64			
3/32			
7/64			
1/8			
5/32			
3/16			